

Oval Track Leaf Spring Mounting Point

Leaf spring mounting angles are one of the most important factors in a leaf spring system. In fact, it is more important to get the mounting angles correct than selecting the proper spring rate. No matter what spring you put on the car it may not perform properly if the angles are misaligned. To counteract the effect of incorrect mounting angles, you may have to install erratic spring rates, shock rates, wheel off sets, unsuitable ride heights, and/or undesirable tire stagger, each of which will cause unpredictable handling characteristics.

The following information and diagram may be beneficial for installing and checking mounting points.

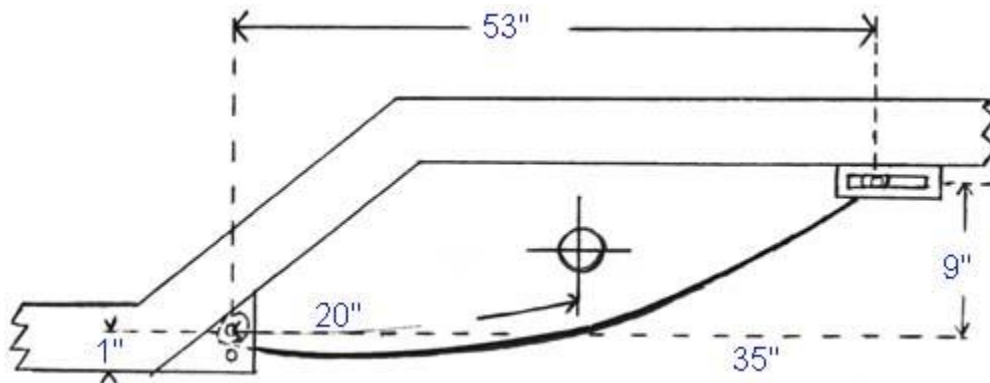

The following information applicable for most oval track Chrysler styles mono and multi-leaf leaf spring applications with the sliders mounted on the rear.

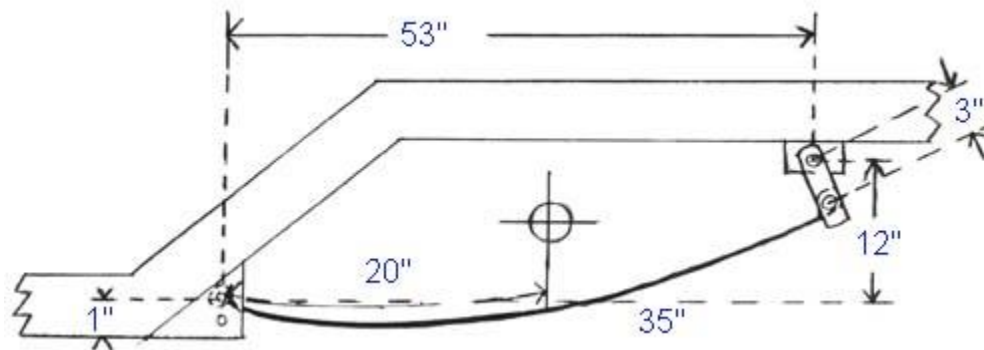

The information below is applicable for most oval track Chevrolet styles, parabolic and multi-leaf leaf spring applications.

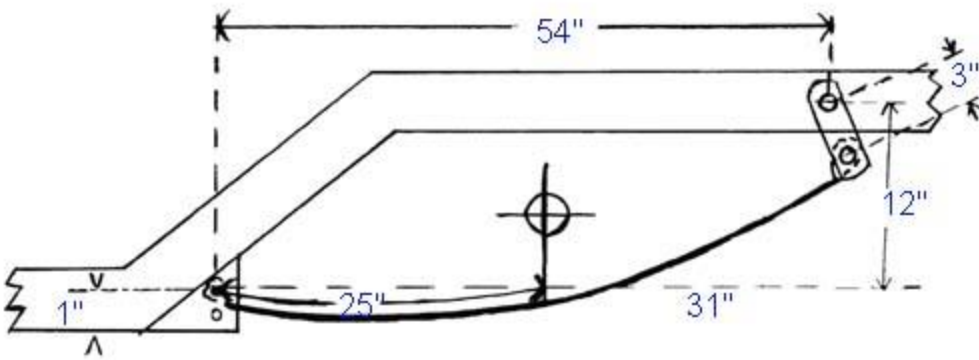

The following diagram illustrates a top view of the rear leaf springs which may be useful in determining a splayed or toed in pattern of the oval track Chrysler set up.

